

Wildwood

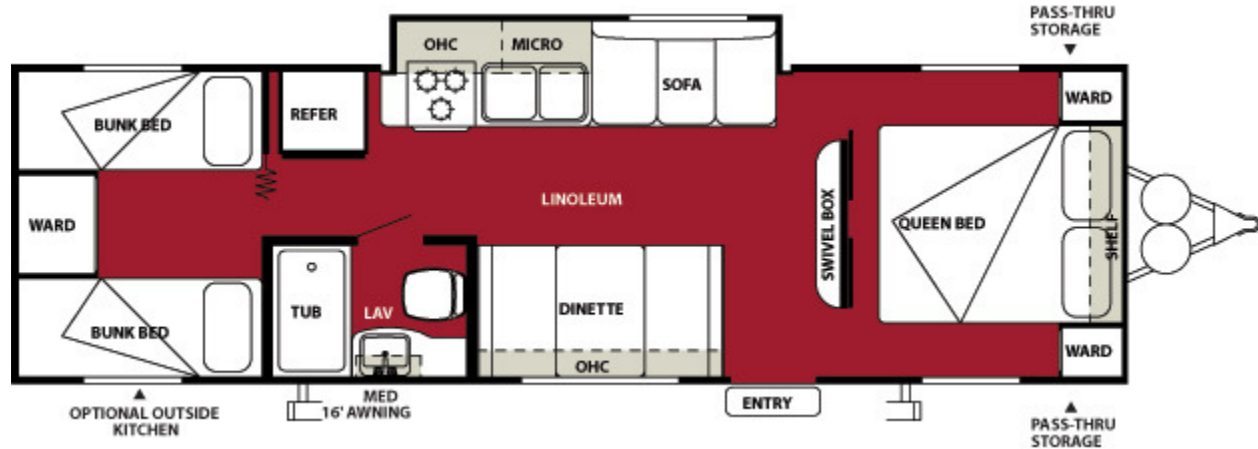

Model 281QB

Dry Hitch Weight	649 lbs. (294 KG)
Unloaded Vehicle Weight	5,438 lbs. (2,467 KG)
Gross Vehicle Weight Rating (GVWR)	TBA (TBA)
Cargo Carrying Capacity	2,173 lbs. (986 KG)
Exterior Length	32 ft. 6 in. (9.9 m)
Exterior Height	10 ft. 2 in. (3.1 m)
Exterior Width	TBA (TBA)
Fresh Water Capacity	40 Gal. (151 L)
Gray Water Capacity	32 Gal. (121 L)
Black Water Capacity	34 Gal. (129 L)
Awning Size	16 ft. (4.9 m)

Floor plans and specifications are based on the latest product information. Forest River, Inc. reserves the right to make changes in drawings and specifications at any time without notice and assumes no responsibility for any errors in the site. The model number does not necessarily reflect the overall length of a particular unit.

www.forestriverinc.com